

The Cleveland Institute of Art and Kent State University Welcome you to Cleveland, Ohio

The development of this conference has been both a responsibility and a great opportunity. At its best, the conference serves to gather the field, to inspire research, to provide a forum for teaching and learning, and to reflect on, represent, and record the best work of the time. After two years of design and planning we have developed a program of lectures, exhibitions, and events that we hope achieves these goals, and in its entirety, will demonstrate the importance of interdisciplinary research in the practice of jewelry, metal arts, and enameling today.

When we first met to shape the conference theme, we discovered that we were both interested in what was happening at the borders of our field as it overlaps or intersects with other disciplines. Gijs Bakker, our Keynote Speaker, came immediately to mind as his own career as an industrial designer, jeweler and educator, epitomizes the theme of "Intersection." We wanted to address the blurring of the lines between our field and others such as design, fashion, and public art. The question, "What is our relationship to popular culture?" deserved attention.

It was also our desire to showcase the importance of our region to the history of metals and enameling through both presentations and exhibitions. We developed themes and sought venues for juried exhibitions that would expose our work to new audiences and provide new challenges for the field. We will witness the best current student work in a slide review and exhibition, and reflect on the lifetime achievements of one of our most esteemed colleagues. In addition to the presentations we have two lively panel discussions scheduled; one that addresses the environmental and political implications of our practice, and the other the intersection of theory and practice.

As students, artists, and teachers, we have all benefited from the enduring contribution that SNAG has made through its publications, programs, and conferences. It has been a pleasure to do this work, and to give back to the field through the development of this conference program. Of course, none of this could be accomplished without our own "village" of volunteers, board members, conference planners and sponsors.

Kathleen Browne and Matthew Hollern

INTERSECTION CONFERENCE SCHEDULE JUNE 22-25, 2005

Please see descriptions of events and programs starting on page 6 for details.

WEDNESDAY, JUNE 22

12:00-7:00	Registration	<i>Registration Office</i>
12:00-5:00	SNAG Auction	<i>Ballroom Assembly</i>
	RECEIVING DONATIONS ONLY (No Bidding)	
1:00-5:00	Vendor Room Open	<i>Dolder Grand, Hassler, Ritz</i>
1:00-5:00	Professional Development Seminar <i>(pre-conference)</i>	<i>Dorothy Fuldheim Ballroom (lobby level - see map on page 28)</i>
6:00-8:00	Pin Swap	<i>Grand Ballroom</i>
	DINNER ON OWN	
8:30PM-???	Student Mixer	<i>Key West Bar (Located in the Galleria, 1 block from the hotel)</i>

THURSDAY, JUNE 23

8:00-5:00	Registration	<i>Registration Office</i>
	SNAG Auction	<i>Ballroom Assembly</i>
9:00-7:00	Vendor Room Open	<i>Dolder Grand, Hassler, Ritz</i>
8:00-8:30	SNAG Voting	<i>6th Floor Lobby</i>
9:00-9:30	General Welcome	<i>Grand Ballroom</i>
	First Timers' Welcome	
	Introduction of SNAG's New President	
	Address by Vice President of 3M, Inc.	
	Conference Preview & Passing of the Torch	
9:30-10:15	Keynote: Gijs Bakker	<i>Grand Ballroom</i>
	"Concept & Beyond: Crossing Borders Between Design & Craft"	
10:15-10:45	Honorary Member Award: John Paul Miller	<i>Grand Ballroom</i>
10:30-11:30	3M Solutions, Bench Demonstrations & Tips	<i>Savoy</i>
	Portfolio Review On-site Sign-up	<i>Across from Registration</i>
10:45-11:15	Coffee Break	<i>Sponsored by KerrLab Grand Ballroom Bar</i>
11:15-12:00	Gretchen Goss	<i>Grand Ballroom</i>
	"In Print/In Person/In Presentation: A Continuing Discussion About Contemporary Enamel"	
12:00-1:30	LUNCH ON OWN	
12:45-1:15	SNAG Voting	<i>6th Floor Lobby</i>
1:30-2:30	3M Solutions, Bench Demonstrations & Tips	<i>Savoy</i>
1:30-3:00	"The Price of Gold" Panel	<i>Grand Ballroom</i>
	Moderated by Susan Kingsley and Christina Miller	
3:00-3:45	Melvin Rose	<i>Grand Ballroom</i>
	"19th Century Guilds to 21st Century Cleveland: An Odyssey"	
3:00-4:00	3M Solutions, Bench Demonstrations & Tips	<i>Savoy</i>

THURSDAY, JUNE 23, continued

3:45-4:15	SNAG Voting	<i>6th Floor Lobby</i>
4:00-6:00	<u>Connections Room</u> Educators' Room <i>Dorothy Fuldheim Ballroom (lobby level)</i> Portfolio Reviews <i>Rockefeller; Hanna, White, Allen, Hope (7th Floor)</i>	
5:00-7:00	Vendor Room Reception	<i>Dolder Grand, Hassler, Ritz</i>
	DINNER ON OWN	
7:30	SPACES Gallery Talk by Kim Cridler	SPACES Gallery <i>(a separate event hosted by SPACES - see flier in conf. bag for details)</i>

FRIDAY, JUNE 24

8:00-4:00	Registration	<i>Registration Office</i>
8:00-3:00	SNAG Auction	<i>Ballroom Assembly</i>
9:00-5:00	Vendor Room Open	<i>Dolder Grand, Hassler, Ritz</i>
8:15-8:45	SNAG Voting	<i>6th Floor Lobby</i>
9:00-9:45	David McFadden "Transgressions and Other Sins of Our Time"	<i>Grand Ballroom</i>
9:00-10:00	3M Solutions, Bench Demonstrations & Tips	<i>Savoy</i>
9:45-10:30	Lyneise Williams "What About Bling: Considering Hip-Hop Jewelry"	<i>Grand Ballroom</i>
10:30-11:00	Coffee Break	<i>Grand Ballroom Bar</i>
10:30-11:30	3M Solutions, Bench Demonstrations & Tips	<i>Savoy</i>
11:00-11:45	Annual Membership Meeting	<i>Grand Ballroom</i>
11:45-12:00	SNAG Voting	<i>6th Floor Lobby</i>
11:45-1:00	LUNCH ON OWN	
12:30-12:45	SNAG Voting	<i>6th Floor Lobby</i>
1:00-1:45	Kathy Buszkiewicz "Value"	<i>Grand Ballroom</i>
1:00-2:00	3M Solutions, Bench Demonstrations & Tips	<i>Savoy</i>
1:45-2:30	National Juried Student Slide Show "Learning Curves"	<i>Grand Ballroom</i>
2:30-3:00	SNAG Voting	<i>6th Floor Lobby</i>
2:30-3:30	3M Solutions, Bench Demonstrations & Tips	<i>Savoy</i>
2:30-4:00	<u>Breakout Sessions:</u> Gallery Owners & Curators Professional Practices SNAG Publications Students	<i>Grand Ballroom</i>
4:00-10:00	Gallery Bus Tour <i>(rotating buses-see brochure in conference bag for details)</i> DINNER ON OWN	

SATURDAY, JUNE 25

8:00-12:00	Registration	<i>Registration Office</i>
8:00-11:00	SNAG Auction	<i>Ballroom Assembly</i>
9:00-2:00	Vendor Room Open	<i>Dolder Grand, Hassler, Ritz</i>
8:30	RAFFLE DRAWING	<i>Auction Site</i>
9:00-9:45	Howard Risatti "Craft versus Design/Recognition versus Understanding"	<i>Grand Ballroom</i>
9:00-10:00	3M Solutions, Bench Demonstrations & Tips	<i>Savoy</i>
9:45	Hotel Room Drawing	<i>Grand Ballroom</i>
9:45-10:30	Gregory Peckham "Catalytic Design: The Role of the Artist in Shaping the Built Environment"	<i>Grand Ballroom</i>
10:30-11:00	Coffee Break <i>Sponsored in part by Tim Roark Imports</i>	<i>Grand Ballroom Bar</i>
10:30-11:30	3M Solutions, Bench Demonstrations & Tips	<i>Savoy</i>
11:00	SNAG AUCTION CLOSES!	
11:00-12:00	Annual Membership Meeting	<i>Grand Ballroom</i>
12:00-12:45	Conversation with the Board	<i>Grand Ballroom</i>
12:45-2:00	LUNCH ON OWN	
1:00-2:00	3M Solutions, Bench Demonstrations & Tips	<i>Savoy</i>
1:00-3:00	SNAG Auction - Winning Bidder Pick-Up	<i>Ballroom Assembly</i>
2:00-3:30	"Theory & Practice" Panel Moderated by Suzanne Ramljak	<i>Grand Ballroom</i>
2:00-5:00	Educators' Dialog	
2:30-3:30	3M Solutions, Bench Demonstrations & Tips	<i>Savoy</i>
7:00-8:00	Cocktails (Cash Bar)/Food	<i>Rock & Roll Hall of Fame & Museum</i>
8:00-9:00	Conference Closing Words/Exhibition in Motion	
9:00-12:00	Dancing/Museum Time	

Hosted By
Cleveland Institute of Art
Kent State University



Official Corporate Sponsor of “Intersection”

**This project is supported in part by an award from
the National Endowment for the Arts**



Proud to Support “Intersection”

Additional Sponsors:

Silver Level (\$1,000 to \$2,000)

Billanti Casting Co. (Co-Sponsor Kathy Buszkiewicz)
Facèré Jewelry Art Gallery (Theory & Practice Panel)
Roger Hollander & Courtenay McGowen (Saturday Night Dance Band)
KerrLab (Coffee Break)
Mobilia Gallery (Co-Sponsor Kathy Buszkiewicz)
Savannah College of Art & Design (National Student Exhibition)
United Precious Metal Refining, Inc. (Neck Wallets)

Pewter Level (\$250 to \$950)

Aaron Faber Gallery (Student Slide Show)
Tim Roark Imports (Co-Sponsor Coffee Break)



Keynote Speaker: Gijs Bakker
*"Concept & Beyond: Crossing Borders
Between Design and Craft"*

Gijs Bakker remarks: "I see no difference between art, craft and design: no difference in value. It all deals with quality. Designing for me is a mentality, a way of communicating with people to express my thoughts." Bakker will talk about his many varied activities in the field, from jewelry and industrial design to education, illustrated by visual images. His presentation will include commentary on the Dutch mentality, coming from political, historical and cultural backgrounds. Jewelry is Bakker's main focus, and he believes it teaches him about human behavior. Through his jewelry he explores all the ideas that are expressed in his designs and organizes work for Droog Design.

Gijs Bakker was trained as a jewelry and industrial designer in Amsterdam and Stockholm. Bakker's designs cover jewelry, home accessories and household appliances, furniture, interiors, public space and exhibitions. His designs have been highlighted by numerous companies. He has lectured at the Design Department of the Academy of Fine Arts in Arnhem and the Delft University of Technology and has been a professor at The Design Academy in Eindhoven since 1987. Together with Renny Ramakers he founded Droog Design in 1993. Bakker and Ramakers are Droog's selectors and art directors. Jewellery and design in collections include: Stedelijk Museum, Amsterdam; Museum het Kruithuis, 's-Hertogenbosch; Powerhouse Museum, Sydney; Denver Museum of Art, Colorado; Cooper-Hewitt Museum, New York; Victoria and Albert Museum, London.

Kathy Buszkiewicz
"Value"

Sponsored by Billanti Casting Co. & Mobilia Gallery

Kathy Buszkiewicz has always explored materials and objects in support of her ideas, whether for jewelry or sculptural work. A number of incredible & synchronistic events led her to communicate ideas about cultural and personal perceptions regarding the worth of objects through the use of U.S. Currency. Although seemingly simple in appearance, the work explores issues relating to materialism, metal's history, environmentalism, commodities exchange, economic status, and social waste. Kathy will present insights into the evolution of the last 12 years of her work.

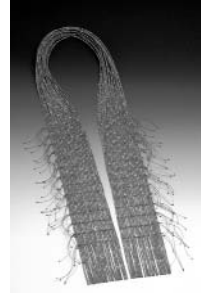

Kathy Buszkiewicz is a Professor of Jewelry and Metals at The Cleveland Institute of Art where she has taught since 1983. She received her MFA from Indiana University. For 3 years, Buszkiewicz was a jeweler/diamond setter in Indianapolis. She traveled to Indonesia observing crafts and culture in 1991. In the same year, she curated "Ethnographic Jewelry: Ritual, Power, Prestige." Her creative work has been shown in numerous national & international exhibitions in the past 30 years. It is represented in over 40 books & publications, and in many private collections. She is a recipient of 3 Ohio Arts Council Individual Artist Grants.

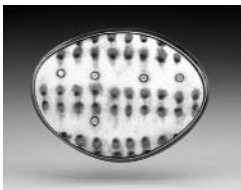

Gretchen Goss (developed with Maria Phillips)

"In Print/In Person/In Presentation: A Continued Discussion About Contemporary Enamel"

As curators of Metalsmith's 2003 Exhibition in Print, "Contemporary Enamel," Gretchen Goss and Maria Phillips presented a group of artists who they believed were pushing this age old process in refreshing, challenging and innovative directions. Two years later, they re-visit many of these artists, as well as several new artists, to examine their continued interest and progress in this medium. They will discuss the collective directions they are witnessing, as well as individual pursuits and interests of the artists.

Gretchen Goss is professor and Department Head of Enameling at the Cleveland Institute of Art. Her work has been exhibited nationally and internationally, and she has taught workshops throughout the country and the U.K. She has been the recipient of two Ohio Arts Council Individual Artist Grants.

Maria Phillips is an independent studio artist and lecturer, working in Seattle, Washington. In 2004, Maria was awarded the Artist Trust/Washington State Arts Commission Fellowship. She has been an Artist in Residence at the John Michael Kohler Arts/Industry Program and the Penland School of Crafts.

**David McFadden**

"Transgressions and Other Sins of Our Time"

"In the past two decades the artificial hierarchies that kept craft and design as stepsisters to Art with a capital A have eroded and, in some instances, entirely disappeared. While many embrace these changes as indicative of a renaissance of creative energy within all fields of the arts, others view the 'blur zone' of art, craft, and design with suspicion," says David McFadden. Change is inevitable in the arts, and McFadden believes it is the duty of a museum such as his to acknowledge and advocate for change. A new generation of artists, designers, and crafts practitioners are enjoying the fluidity of their defined roles. This talk will look at the pioneers who have led the way and the growing number of creative individuals in art, craft, design, fashion, architecture, interior design, and theater that are moving the field forward.

David Revere McFadden is currently Chief Curator and Vice President for Programs and Collections at the Museum of Arts & Design (formerly American Craft Museum) in New York City. McFadden did his undergraduate and graduate work at the University of Minnesota, and received his graduate degree in the History of Art, with a secondary major in Chinese history. McFadden has organized over 150 exhibitions on decorative arts, design, and craft, and has published over 100 books, articles, catalogues, and reviews worldwide.

Greg Peckham

"Catalytic Design: The Role of Artists in Shaping the Built Environment"

The work of architects and artists is unified in the world's most important buildings and public spaces. In creating successful public art, artists and architects must envision buildings, civic infrastructure, and public spaces in ways that inspire and bring new life to cities and the people who live in them. Artists are again playing a pivotal role in shaping the built environment of our cities.

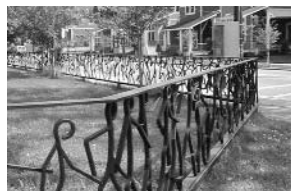

Greg Peckham is the Project Director and currently Acting Director of Cleveland Public Art. Greg came to CPA in 2002 to manage the public art master planning process for the Regional Transit Authority's \$200 million Euclid Corridor Transportation Project. Since then he has been involved in several of the organization's major initiatives including the lighting of the historic Cleveland Trust building, NY artist Brian Tolle's two-year installation on Mall B in Downtown Cleveland, as well as working with the City of Cleveland and City Council to pass the new Percent for Art ordinance. Prior to joining CPA, he worked as the staff planner for University Circle Incorporated's Department of Community Development and Planning. Greg has also worked in public education and as a legislative assistant in the Ohio Senate.



Howard Risatti

"Craft versus Design/Recognition versus Understanding"

Through industrial-technological production Design now overshadows Craft and the hand in making objects of use. So beneficial has the relationship between Design and production been that it is difficult to realize that through such production (rather than political or ideological mandate), Design has transformed the world and our understanding of it. By comparing Craft and Design, this presentation

seeks to address such issues as well as the question of whether or not "understanding" can be based on appearance or must it entail a deeper engagement with the object and hence, with the world.

Howard Risatti teaches Modern/Contemporary Art and Critical Theory and chairs the Department of Craft/Material Studies at Virginia Commonwealth University. His writings have appeared in Art Journal, Artforum, New Art Examiner, Artscribe, Latin American Art, The Chronicle of Higher Education, Woman's Art Journal, Art Criticism, The Studio Potter, and Ceramic Art & Perception. Recent writings include "Double Negative," for Sculpture Magazine and "Contemporary American Ceramic Trends," for Ceramics Monthly-Korea. He is a consultant for the upcoming PBS prime-time series, "Craft in America."

Melvin Rose

"19th Century Guilds to 21st Century Cleveland: An Odyssey"

Rose Metal Industries (formerly Rose Iron Works) has supplied decorative metalwork for Ohio homes, businesses, public and religious organizations for over 100 years. After three generations, it is still recognized as the most important ornamental forge in the region. Melvin Rose, son of founder Martin, will provide a pictorial narrative of Rose work from the late 19th century to the present. Of particular interest, he will highlight their adoption of technological and material advances without sacrificing the graceful execution that is the hallmark of Rose work.

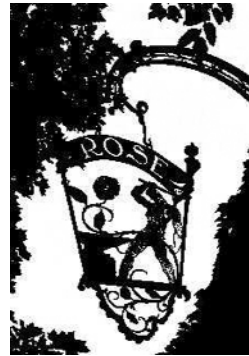

Martin Rose, a master "Kunst Schlosser" art blacksmith, opened shop in Budapest in 1897. He reestablished himself in Cleveland in 1904. Valuing traditional education, he sent each of three sons to study in Europe. Melvin studied for 4 years in Vienna before attending the Cleveland Institute of Art (1940, Industrial Design). He and brother Milton introduced sandblasted carved glass to Cleveland, stand-alone and in combination with metal. Melvin collaborated with designers Viktor Schreckengost, John Paul Miller, and Elsa Vik Shaw on both metal and glass murals installed in Cleveland and elsewhere. Rose metalwork has appeared in museum exhibitions in the U.S. and Canada.

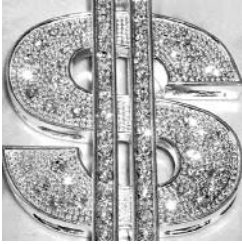

Lyneise Williams

"What About Bling? Considering Hip-Hop Jewelry"

Jewelry has been a major component in the rap music phenomenon since its beginnings in the late 1970's. Indeed, bling was and continues to be one of the most well-recognized signs of this musical genre. This larger-than-life jewelry calls attention to itself and the wearer through its opulence. Like the music that generated it, hip-hop jewelry has moved far beyond the urban settings of New York where it was popularized by young men and women of the Bronx. The fashionable trend towards hyper-shiny materials and encrusted configurations we see in the market today is indebted to bling. Her presentation will explore the impact of hip-hop jewelry in American culture.

Lyneise Williams is a Carolina Post-Doctoral Fellow in the Art Department at the University of North Carolina at Chapel Hill. In May 2004, she received her PhD in the Department of the History of Art from Yale University. Williams' research focuses on the visual culture of the African Diaspora, with a specialty in Black presence in Latin America.

National Juried Student Slide Show – "Learning Curves"

Presented by Kim Tatalick (developed with Lanelle Keyes)

Sponsored by Aaron Faber Gallery

This animated presentation will showcase student work from various metals education programs across the United States. The program will include information about the educational institutions as well as the departments from which the work is generated. The title "Learning Curves," reflects that student work is representative of applied knowledge. This presentation emphasizes that knowledge is objectified through a broad scope of interpretations, mirroring the range of individuals and schools that are advancing the future of our discipline. Jurors: Kim Tatalick & Lanelle Keyes

Lanelle Keyes chairs the Metals and Jewelry Department at the Savannah College of Art and Design where she teaches both metalworking and accessory design courses. She serves on the SNAG Nominations and Elections committee.

Kim Tatalick holds an MFA from Tyler School of Art. She is currently teaching in the Metals and Jewelry Department at the Savannah College of Art and Design. Her work was recently included in "Innovations," an exhibition sponsored by SFA Gallery in Nacogdoches TX.



“The Price of Gold” Panel
*Moderated by Susan Kingsley
and Christina T. Miller*

Panelists:

Tom B.K. Goldtooth

Glenn Miller

Payal Sampat

We are in the midst of a worldwide gold rush. Enormous internationally owned mining corporations are rapidly consuming wilderness areas, contaminating watersheds, destroying ecosystems and imperiling the economies of poor nations and the well-being of indigenous peoples throughout the world. Our lives and livelihoods are linked to metal, yet we forget that the earth

and mining provide our raw material. The metals we use have costs not included in the price we pay.

Moderators:

Susan Kingsley and **Christina Miller** are metalsmiths with shared knowledge and interest in mining issues and are pleased to collaborate with this distinguished panel of experts. Following their brief introduction highlighting the myths and realities of gold, each panelist will speak. There will be time at the end for discussion.

Panelists:

Tom B.K. Goldtooth, Executive Director of the Indigenous Environmental Network and a long time leader in Native social, economic and environmental justice issues will discuss the spiritual value of land, human rights and what is being done now to protect and defend indigenous communities.

Glenn C. Miller, Ph.D., Professor of Environmental and Resource Sciences at the University of Nevada has been active in conservation organizations for many years and is an internationally recognized technical and policy expert on mining. He will bring his “dirty picture show” of hard rock mining gone wrong and will discuss plans for establishing an independent certification process for responsibly mined and recycled gold.

Payal Sampat is International Campaign Director at EARTHWORKS, a non-profit dedicated to protecting communities and the environment from the destructive impacts of mining and is co-director of the No Dirty Gold campaign. A native of India, she holds degrees from St. Xavier’s College, Bombay and Tufts University. She will discuss mining from a worldwide perspective, describe how activism works and provide an update on the international campaign.

“Theory & Practice: A Dialog Between Educators and Practitioners”

Sponsored by Facère Jewelry Art Gallery

Moderated by Suzanne Ramljak

Panelists: *Marcia Macdonald*
 Myra Mimplitsch-Gray
 Joe Wood
 Jan Yager

Production artists and educators are often perceived as existing at two ends of the spectrum. For this panel, two representative educators and two representative studio practitioners are brought together to discuss areas of overlap, intersection, diversion and conflict, and what assumptions and expectations each population have about and for each other. The role of academic preparation for careers in various aspects of the field also will be discussed.

Moderator:

Suzanne Ramljak, a writer, art historian, and curator, is currently editor of *Metalsmith* magazine. She was formerly curator of exhibitions at the American Federation of Arts, and served as editor of *Sculpture* and *Glass* magazines, as well as associate editor of *American Ceramics* magazine.

Panelists:

Marcia Macdonald received her MFA in Jewelry & Metals from University of Massachusetts, North Dartmouth. Marcia divides her time between producing one-of-a-kind jewelry and limited-edition production work that she exhibits at such venues as the Smithsonian Museum of Art Craft Show and the Philadelphia Museum of Art Craft show. She recently served on the Board of Directors for SNAG.

Myra Mimplitsch-Gray received her MFA from the Cranbrook Academy of Arts in Bloomfield Hills, MI. She is currently Professor of Art in the Metals Program at the State University of New York at New Paltz. She is the recipient of an Individual Artist Fellowship from the Louis Tiffany Foundation and the National Endowment for the Arts.

Joe Wood received his MFA from Kent State University. He is currently Professor and program coordinator for the Metals Department at Massachusetts College of Art, Boston, MA. His artwork is in the collections of the Renwick Gallery of the Smithsonian Institution and The Charles A. Wustum Museum of Fine Arts, Racine, WI.

Jan Yager, a mixed media jeweler, received her MFA from Rhode Island School of Design. Her artwork is included in collections of the Renwick Gallery of the Smithsonian Institution and the Victoria and Albert Museum in London. She is the recipient of an Individual Artist Fellowship from the National Endowment for the Arts and the Pew Fellowship in the Arts.

EDUCATORS DIALOG

“Preparation for Practice in the Field”

This year, as mandated by the membership, the Educators Dialog has been integrated into the conference schedule. The format for this program was designed to dovetail with the Theory and Practice Panel that will take place right before it. The Educators Dialog will engage those who are practicing in the field and provide an open forum for their responses to higher education and career preparation.

The 2005 Educators Dialog will focus on what efforts educators and institutions are taking to prepare students for practice in the field. This career preparation varies greatly from program to program. A panel of professionals consisting of a curator, a gallery director, and two recent Metals graduates (one following a production track and the other creating one-of-a-kind work) will give their perspectives on the strengths and weaknesses of higher education career preparation and how these issues might be addressed. Questions will be taken from the audience during the program.



HONORARY MEMBER AWARD

John Paul Miller

For more than sixty years, John Paul Miller has been a great contributor to the field of jewelry and design through his career as a teacher, scholar, and artist. He is a local hero and a national treasure.

John Paul Miller began his career following graduation from the Cleveland Institute of Art in 1940, teaching freshman classes at the college. In 1945, following the war, he accepted a position to teach design at the Institute. That decision defined his work and career. He taught students the concepts and disciplines of design, color theory, drawing, and

painting. In later years he taught jewelry with Frederick Miller, with whom he made documentary films on silversmithing, granulation, and enameling.

Miller's efforts to rediscover, master, and document the Etruscan technique of granulation defined his work in scholarship and in the studio. He revived interest in an ancient technique and challenged audiences with new and innovative designs. As a designer, he changed contemporary understanding of enameling and goldsmithing.

His work has been exhibited in major museums throughout the world and is part of the permanent collections of the Cleveland Museum of Art, Boston Museum of Fine Art, Yale University Museum and many other public and private institutions.

John Paul Miller exemplifies the mission of the Society of North American Goldsmiths through his commitment to innovation, scholarship, and education. He is a true ambassador for his field to his local community and the greater worldwide art community.



3M SOLUTIONS, BENCH DEMONSTRATIONS AND TIPS

(3M Presentations will be held in the Savoy Room on the 6th Floor)

3M is proud to be the Official Corporate Sponsor of the 2005 SNAG Conference, "Intersection." During this year's conference, daily presentations are scheduled and individuals are encouraged to bring their own work to try out 3M's products. Several focus products will be presented including the new 3M™ FX Polishing Wheels, Trizact™ products, respirators, and more. Demonstrations will be done on several applications such as gold, silver, precious metal clay, titanium, and brass.

Each 3M Presentation will include:

- *Live Demonstrations - New Product Introduction, Product Suggestions*
- *Tips Segment - Reducing Polishing Steps*
- *3M Solutions Website information*
- *3M/SNAG Survey Follow-up - What educators need, what students could use, product opportunities, how to simplify ordering*
- *Drawing (one winner per session) - set of 3M FX Polishing Wheels (\$115.00 value)*

3M Solutions, Bench Demonstrations and Tips Schedule:

Thursday, June 23

10:30-11:30 AM

1:30-2:30 PM

3:00-4:00 PM

Friday, June 24

9:00-10:00 AM

10:30-11:30 AM

1:00-2:00 PM

2:30-3:30 PM

Saturday, June 25

9:00-10:00 AM

10:30-11:30 AM

1:00-2:00 PM

2:30-3:30 PM

BREAKOUT SESSIONS

2:30-4:00PM, Friday, June 24

Breakout sessions are organized to provide a forum for discussion about specific issues in various aspects of the metals field. This year, four separate sessions have been organized. All four sessions will take place in a different section of the Grand Ballroom this year. Feel free to move between the four sessions.

Gallery Owners & Curators Breakout

This year's breakout will be a conversation between gallery owners, curators, museum personnel, and artists about marketing. What succeeds and why? Join us for a discussion followed by questions, answers and opinions. Bring your best ideas!

Coordinator: Karen Lorene, Facère Jewelry Art Gallery

SNAG Publications Breakout

(formerly Metalsmith Magazine Breakout) Join Metalsmith Editor, Suzanne Ramljak, SNAG News Editor, Nancy Monkman and Sean Gilson, SNAG News Technical Editor, for a discussion about the editorial policies and direction of these two SNAG publications.

Professional Practices Breakout

This year's session will be an open forum. Come with questions about any aspect of a professional life as a jeweler or metalsmith or with information to share with others.

Moderators: Don Friedlich and Barbara Minor

Students Breakout

This is a time for students to get together and network, discuss concerns and ask questions. What information is most valuable to you right now? Moderators: Kim Tatalick and Rod McCormick

PRE-CONFERENCE EVENT: Wednesday, June 22

Professional Development Seminar

1:00-5:00PM

Dorothy Fuldheim Ballroom (lobby level)

The pre-conference Professional Development Seminar (formerly the Professional Practices Workshop) was developed to provide information on a wide range of topics concerning establishing and maintaining a career as a professional studio jeweler or metalsmith. It is designed to serve students, emerging artists and established professionals.

Three presentations are planned this year. The first will be Thomas Mann speaking about pricing your work.

Second, Roberta and Dave Williamson will discuss public relations and the mainstream press media.

The third presentation will attempt to demystify the jurying process. A distinguished panel of jurors, including Mike Holmes of Velvet da Vinci Gallery, Patricia Faber of Aaron Faber Gallery and Karen Lorene of Facèré Jewelry Art Gallery, will score slide submissions from twenty-five artists and then discuss the rationale behind their scoring.

Don Friedlich will serve as moderator of the seminar. This program is **FREE** and no conference registration is required. Come for all or part of the seminar.

Looking for the Educators Dialog?

By mandate of the SNAG membership at the 2004 conference, the Educators Dialog has been integrated into the regular conference program this year. It will be held directly after the Theory and Practice Panel Discussion on Saturday, June 25 at 3:30PM, in the Grand Ballroom. Want details on the program for the 2005 Educators Dialog? See **page 13**.

CONNECTIONS ROOM: Thursday, June 23 4:00-6:00PM

The **Connections Room** provides a forum to help students, educators, emerging artists, and art professionals make Connections. The Connections Room includes two separate events - **Portfolio Reviews** & the **Educators Room**. See details on each event below.

Portfolio Reviews *Rockefeller, Hanna, White, Allen, Hope (7th Floor)*
(Separate registration is required for this event)

Portfolio Reviews are for emerging artists and graduating students. Gallery representatives, curators, and other professionals in the metals field will be available by appointment to review portfolios and provide professional advice and guidance. The goal is to create an opportunity for emerging artists to meet and hear from seasoned artists and arts professionals that can help them in the development and advancement of their artistic careers. All participants must register for a review. Artists who have not pre-registered by email can register in-person Thursday, June 23 from 10:30 -11:30 AM across from the conference registration office.

Portfolio Reviewers at print time include:

Gijs Bakker, Designer and Professional Metalsmith
Boris Bally, Professional Metalsmith
Gail M. Brown, Independent Curator
Don Friedlich, Professional Metalsmith
Karen Lorene, Facéré Jewelry Art Gallery
Bruce Metcalf, Professional Metalsmith and Writer
Howard Risatti, Historian, Writer, and Critic
Dave and Roberta Williamson, Professional Metalsmiths
(more reviewers to be added by the time of the conference)

Educators Room *Dorothy Fuldheim Ballroom (lobby level)*

Educators from universities, colleges, schools, art centers, and other educational programs across the United States will be included in the Educators Room. Educational programs will have representatives present to show slides of student work, answer questions, and have printed information on hand. This is a perfect opportunity for artists and students to learn about the educational possibilities available to them, and to meet faculty and current students. This is also an opportunity for educators to gather information for their students who are unable to attend the conference. Artists and students do not have to register separately to attend the Educators Room.

Participating Educators at print time include:

<i>Alberta College of Art and Design (AB)</i>	<i>Savannah Coll. of Art and Design (GA),</i>
<i>California College of the Arts (CA)</i>	<i>Smithsonian/Corcoran Masters Program -</i>
<i>Columbus Art Center (OH)</i>	<i>History of American Decorative Arts (DC)</i>
<i>Craft Alliance (MO)</i>	<i>SUNY New Paltz (NY)</i>
<i>E. Carolina Univ.-Sch. of Art and Design (NC)</i>	<i>Syracuse University (NY)</i>
<i>Edinboro Univ. of Pennsylvania (PA)</i>	<i>Towson University (MD)</i>
<i>Haystack Mtn. School of Crafts (ME)</i>	<i>University of the Arts (PA)</i>
<i>Indiana University (IN)</i>	<i>Univ. of IL at Urbana-Champaign (IL),</i>
<i>Kent State University (OH)</i>	<i>University of Kansas (KS)</i>
<i>Ontario College of Art and Design (ON)</i>	<i>University of North Texas (TX)</i>
<i>Penland School of Crafts (NC)</i>	<i>University of the West of England: The</i>
<i>Pratt Institute (NY)</i>	<i>International Enamel Archive (UK)</i>
<i>Rhode Island School of Design (RI)</i>	<i>Univ. of Washington School of Art (WA)</i>
<i>San Diego State University (CA)</i>	<i>Western Michigan University (MI)</i>

(more names of educators may be added by the time of the conference)

Pin Swap

6-8:00PM

Wednesday, June 22

Grand Ballroom

The Pin Swap is SNAG's traditional conference ice-breaker. Swap your pins or beads with other conference-goers over hors d'oeuvres and drinks. Be sure to save a pin for the volunteers who will be collecting pins for the Silent Auction, as well!

Student Mixer

8:30-???

Wednesday, June 22

Key West Bar

(the bar is located in the Galleria, one block from the hotel)

Organized for the first time this year, the student mixer is designed to help students connect with their peers early in the conference. Mingle with other students from all over the country and start talking about the things that are important to you! Admission to the Key West Bar is open to all ages, and anyone can attend.

Enamel Archive

4-6:00PM Thursday, June 23 Dorothy Fuldheim Ballroom (in Connections Room)

The International Vitreous Enamel Archive was recently established at the University of the West of England, Bristol. This major international archive website will enable study and research of contemporary enamel, with the aim of establishing enamel as a medium of exploration for contemporary artists. As a starting point one hundred artists who use enamel in their work have each contributed ten images and information which has been transferred into a systematic database, the basis for a digital website. Come view the website and talk to its founder, Elizabeth Turrell, in the Connections Room.

Vendor Room Reception

5-7:00PM

Thursday, June 23

Dolder Grand, Hassler, Ritz

Join us for an open-bar party in the Vendor Room! The vendors will be open late this evening and are at your service, so there's no better time to spend money on yourself. Happy hour snacks and drinks.

Annual Membership Meetings

Grand Ballroom

11-11:45AM, Friday, June 24

and

11AM-12PM, Saturday, June 25

SNAG is your business - learn how it works. SNAG's Annual Membership Meetings will take place during the conference and they are our opportunity to participate in the process that brings us what we expect from SNAG membership - from Metalsmith Magazine, SNAG News, and SNAGnet to grants, workshops, and the conference itself. The meeting provides a forum to both report the activities and status of the organization to the members, and for members to express their concerns to the organization as a whole. It is our opportunity to make our concerns known to the governing board of directors and fellow members. Meeting agendas are in your conference registration packets. The board of directors invites and encourages you to partake in the process that guides your organization.

Conversation with the Board

12-12:45PM

Saturday, June 25

Grand Ballroom

This year, the second membership meeting will be followed by a "conversation with the board" from 12-12:45PM. This new feature is designed to give members a chance to "talk back" to board members directly.

SNAG Voting*6th Floor Lobby (see below for times)*

Voting is easy and it is one way that all members can play a role in the shaping of SNAG because every single member is eligible to vote. In this election SNAG's membership will choose one board member, one Nominations and Elections Committee member and vote on proposed changes to the SNAG By-Laws. Candidates will be introduced during the first session of the annual membership meeting (see page 18). Results of the SNAG election will be announced during the second session of the annual meeting.

<p><u>VOTING TIMES:</u></p> <p>Thursday, June 23 8:00-8:30AM 12:45-1:15PM 3:45-4:15PM</p> <p>Friday, June 24 8:15-8:45AM 11:45AM-12:00PM 12:30-12:45PM 2:30-3:00PM</p>
--

SNAG Member Services Table / Information*6th Floor Lobby*

Come to the member services table to pick up printed materials, such as information and application forms for the Endowment scholarship, MOGHS, and Workshop Grants program. Or find out more about SNAG and what we provide to members and to the field. In between presentations, a board member will be here to answer questions about SNAG and Metalsmith magazine. General conference-related questions can be answered here, as well.

Free Literature Tables*6th Floor Lobby*

Pick up free metals-related magazines, postcards, brochures and catalogues from businesses, schools and individuals throughout the conference.

Raffle for the Educational Endowment*Drawing 8:30AM Saturday, June 25 Auction Site (Ballroom Assembly)*

This year's raffle gives ticketholders a chance to win some AMAZING goodies! By buying a ticket, you are automatically entered to win one of Jack DaSilva's anvils, a Boris Bally chair, and a host of other prizes from tools to casting services! Tickets are still only \$5.00 each, or five for \$20, and they can be purchased from roving ticket-sellers or at the Silent Auction site (Grand Ballroom Assembly area). The drawing will be held at the Silent Auction site at 8:30AM on Saturday, June 25. 100% of the proceeds from the raffle go to Educational Endowment student scholarships.

NEW! Hotel Room Drawing*Saturday, June 25, 9:45AM*

New this year! The morning of June 25, we will draw 5 hotel room numbers. If yours is one of the 5 numbers drawn, your stay (and your roommates') will be **FREE!** SNAG will pay the room and tax for those 5 rooms, for all 4 nights of the conference! You must be staying at the Crowne Plaza to qualify.

SNAG SILENT AUCTION *Ballroom Assembly*
 (See Auction Hours below)

Help SNAG fulfill its educational mission by supporting the Silent Auction! Visit the Silent Auction booth and bid on some of the outstanding items that have been donated this year. We have jewelry, metalwork, tools, books, stones, and all kinds of other things related to the metalsmithing world. Be sure to look for this year's collection of pins from the Pin Swap!

SNAG exists to promote and facilitate education. All proceeds from the SNAG Auction are divided equally between the SNAG Educational Endowment (scholarships for undergraduate and graduate students in metals programs) and Educational Programming (Workshop Grants, Minority Outreach Grants to High Schools, Audio/Visual Rental Service and Lecture Series).

So be sure to stop by to browse, and support SNAG's Educational Programming and Endowment by taking something home with you. See you at the auction!

The 2005 SNAG Auction Coordinators:
 Sharon Massey, Melissa Manley, Liz Page & Allyson Cooper

Making Donations:

The auction will not be open for bidding on Wednesday. Instead we will only be accepting donations on this day (from 12- 5PM), so if you waited until you arrived at the conference to donate your piece to the auction, Wednesday is the day to donate! Also, look for auction volunteers on Wednesday night at the Pin Swap. Talk to them if you want to donate one of your pins to be auctioned in a group. We did this last year and raised almost \$300 from the pins of generous pin-swap-pers alone!

Getting a Bidder Number:

To bid on items in the Silent Auction, you must have a bidder number. If you checked off the "Please assign me a bidder number" box on your conference registration, you should have a bidder number on the back of your conference name tag. If you did not pre-register for a bidder number, you can get one at the auction booth or at the Bidder Registration Table in the lobby on Wednesday or Thursday morning. You must have a credit card to get a bidder number, but you can pay for any items you win at the auction with cash, check or credit card.

Item Pick-Up:

All winning bids and unclaimed donations must be picked up on Saturday, June 25 between 1:00 and 3:00 PM - no exceptions!

Auction Hours:

June 22:	12-5:00PM	Bidder Registration/Receiving Donations
		NO BIDDING TODAY
June 23:	9AM-5:00PM	Auction Open For Bidding
June 24:	8AM-3:00PM	Auction Open For Bidding
June 25:	8-11:00AM	Final Hours to BID
	11:00AM	AUCTION ENDS!!
	1-3:00PM	Winning Bidder Pick Up

VENDOR ROOM*Dolder Grand, Hassler & Ritz*

Purchase tools, supplies, gemstones and books right from these top vendors! Try out products and get answers to all your questions directly from the source.

Vendor Room Hours:

Wednesday, June 22	1:00 - 5:00PM
Thursday, June 23	9:00AM - 7:00PM
	<i>(Vendor Room Reception 5:00 - 7:00PM)</i>
Friday, June 24	9:00AM - 5:00PM
Saturday, June 25	9:00AM-2:00PM

SNAG 2005 VENDOR PARTICIPATION*(at time of printing)*

Allcraft, 135 West 29th Street, Suite 205, New York, NY 10001
 (800) 645-7124 / fax: (800) 645-7125 / allcrafttools@yahoo.com
 Contact: Tevel & Sarah Herbstman
(tools & equipment/Trish McAleer book)

Bill Gangi Multisensory Arts, P.O. Box 64141, Tucson, AZ 85728-4141
 (520) 577-7574 / gangi@flash.net
 Contact: Bill Gangi/Sharon Fosko - Director of Marketing
(unusual gemstones)

Bluebird Gemstones, P.O. Box 12284, Portland, OR 97212
 (503) 281-4101 / fax: (503) 232- 8752 / funhog@teleport.com
 Contact: Karen Sinizer/Greg King, Stonecutter
(gemstones, opals)

Bonny Doon Engineering, 250 Tassett Court, Bonny Doon, CA. 95060
 (831) 423-1023 / fax: (831) 423-1605
 www.bonnydoonengineering.com / marshall@bonnydoonengineering.com
 Contact: Lee Marshall/Phil Poirier
(hydraulic press supplies and equipment)

Centerpiece (Abbott Designs), P.O. Box 1311 Roswell, GA 30077
 (770) 594-0561 / fax: (770) 552-9186 / cabbott@hotmail.com
 Contact: Gary Abbott, Judy McMillan
(gemstones)

Charon Kransen Books, 3456 W. 25th St., Apt. 2, New York, NY 10011
 (646) 431-4517 / chakran@earthlink.net
 Contact: Charon Kransen, Vernon Theiss
(art books)

Downeast Trading Company, P.O. Box 349, Middlebury, VT 05753
 (800) 626-5700 / fax: (802) 388-7242
 www.downeasttrading.com / downeast@sover.net
 Contact: Rick Winslow
(chains, etc.)

(Vendor Room Participation, continued. . .)

DuftyWeis Opals, P.O. Box 246, Maysville, KY 41056
(800) 948-5058 / (606)564-7500 / fax: (603) 949-6372 / cell: (606) 584 0168
robyndufty@yahoo.com / robyn@duftyweis.com
contact: Robyn Dufty
(opals)

East West Dye Com, P.O. Box 12294 Roanoke, VA 24024
(800) 407-6371 / (540) 362-1489 / fax (540) 362-7425
abbey@eastwestdye.com
Contact: Abbey Lawhorn
(beads, chains, anodizing, etc.)

Otto Frei (formerly Frei & Borel), 119 3rd Street, Oakland, CA 94604
(510) 832-0355 / fax: (510) 834-6217 / john@ottofrei.com
Contact: John Frei
(tools and equipment)

John Henkel Casting Services, 16 Union St., Brunswick, Maine 04011
(207) 729-3599 / Fax (207) 729-3723 / Cell (207) 522-7464
jahrenkel@gwi.net
Contact: John Henkel
(casting)

Jason Penn Designs, 458 S. Stratford, Tucson, AZ 85716
(520) 241-4543/ fax: (520) 327-1662 / jason@flowervases.com
Contact: Jason Penn
(Gemstones)

King's Ransom, 3030 Bridgeway, Suite 209, Sausalito, CA 94965
(877) 331- 2650 / fax: (415) 331-9402
www.pearlgoddess.com / bettysue@pearlgoddess.com
Contact: Betty Sue King, Marie Scarpa
(opals and pearls)

Eugene McDevitt (*sharing booth with Stan Thompson Enterprises*)
P.O. Box 20288, St. Petersburg, FL 33742
(727) 742-5471 / gene@koroit.com / www.koroit.com
contact: Gene McDevitt
(opals)

Penny Nisenbaum, P.O. Box 27501, San Francisco, CA 94127
(415) 564-1843 / penrocks@mindspring.com
Contact: Penny Nisenbaum
(gemstones)

Reactive Metals Studio, P.O. Box 890, Clarkdale, AZ 86324
(928) 634-3434 / fax: (928) 634-6734 / reactive@sedona.net
Contact: Bill Seeley, Deborah Allen-Adair, Michele Bowers
(married metals, some tools, including Sparkie)

continued. . .

(Vendor Room Participation, continued. . .)

Rio Grande, 7500 Bluewater Rd. NW, Albuquerque, NM 87121
(505) 839-3342 / fax: (505) 839-3248 / sgurrie@tbg.riogrande.com
www.riogrande.com
Contact: Sara Gurrie
(tools and equipment)

Stan Thompson Enterprises *(sharing booth with Eugene McDevitt)*
P.O. Box 85213, Seattle, WA 98145
(206) 463-6970 / fax: (206) 463-9791 / stan@asams.net
contact: Stan Thompson
(computer business management & inventory programs)

Tim Roark Imports, 1401 Peachtree St., Ste.234, Atlanta, GA 30309
(404) 872-8937 / fax: (404) 872-9346 / trimports@aol.com
Contact: Tim Roark
(gemstones)

White Cloud Co., P.O. Box 750220, Forest Hills, NY 11375
104-20 Queens Blvd., room 19Y
(718) 830-3866 / fax: (718) 830-3280 / cell: (917) 496-1768
vinijain@hotmail.com
contact: Dinesh Jain
(gold and silver beads)

Exhibitions/Gallery Bus Tours

4-10:00PM, Friday, June 24

Many thanks to the

Ohio Arts Council

and other generous sponsors of this year's exhibitions:

Bowling Green State University
Cleveland Institute of Art
Cleveland Museum of Art
Cleveland Natural History Museum
Ferro Corporation
Heights Arts Collaborative
Kendall College
Kent State University
Kent State University Jewelry- Students Coop
Miami University
Ohio Wesleyan University
Potter & Mellen
Rock & Roll Hall of Fame and Museum
SPACES
University of Akron

All shows marked with an asterisk (*) are featured on the bus tours on Friday night. For detailed information about the bus tours, please refer to the Bus Tour Brochure that is included in your conference bag. Note: Kim Cridler's talk at SPACES is Thursday night, not Friday.

JURIED EXHIBITIONS:

The Influence of Rock & Roll

June 25 - August 7, 2005

June 25: Exhibition opens for SNAG Party

June 26: Exhibition opens to the public

A juried exhibition of jewelry, metalwork and enameling influenced by Rock & Roll. Jurors: Boris Bally & Wendy Thumudo

Rock and Roll Hall of Fame and Museum
1 Key Plaza, Cleveland, Ohio 44114-1022 / (216) 781-7625



Ramirez

*** On The Verge - SNAG 2005 Juried Student Exhibition**

June 24 - July 25, 2005

June 24, opening reception, SNAG Gallery Tour 4-10:00PM

Juried by Kathy Buszkiewicz and Tom Muir.

Sponsored by Savannah College of Art & Design.

The Reinberger Galleries,
The Cleveland Institute of Art

11141 East Blvd., Cleveland, Ohio 44106 / (216) 421-7000



Dhein

*** Resources: Steel, Rubber, Coal and Salt**

June 11 - August 21, 2005

June 24 opening reception

SNAG Gallery Tour 4-10:00PM

A juried exhibition featuring work inspired by the materials of the industry of Ohio. Jurors: Sue Amendolara, Cappy Counard and Carol Kumata

Cleveland Museum of Natural History

1 Wade Oval Drive, University Circle, Cleveland, OH 44106 / (216) 231-4600

continued...

CURATED EXHIBITIONS:

*** Enamel: Beyond the Object**

June 24 - August 5, 2005

June 23 lecture: Kim Cridler

June 24, opening reception

SNAG Gallery Tour 4-10:00PM

Artists working with enamel consider installation.

Curator: Gretchen Goss

SPACES Gallery

2220 Superior Viaduct, Cleveland, Ohio 44113 / (216) 621-2314



Gertler



Higashi

*** In Print / In Presentation:**

A Continuing Examination of Contemporary Enamel

June 24 opening reception

SNAG Gallery Tour 4-10:00PM

Curators: Gretchen Goss and Maria Phillips

The Thomas Riley Gallery

28699 Chagrin Blvd. #260, Woodmere, Ohio 44122

*** Educators / Educated:**

Jewelry and Metals in Ohio

June 24, opening reception

SNAG Gallery Tour 4-10:00PM

Curator: Gail M. Brown

The Reinberger Galleries,

The Cleveland Institute of Art

11141 East Blvd., Cleveland, Ohio 44106-171 / (216) 421-7000



DaSilva



Shiga

*** Embracing the Sacred and the Secular: Reliquaries in Contemporary Metals**

June 24, SNAG Gallery Tour 4-10:00PM

Curators: William Busta & Catherine Butler

The Heights Arts Collaborative

2163 Lee Road, Cleveland Hts. Ohio

(216) 371-3344

*** 200 Rings**

June 1 - July 17, 2005

June 24, SNAG Gallery Tour 4-10:00PM

Curators: Elizabeth Shypert & Mike Holmes

Gallery M

1667 East 40th Street, Cleveland, Ohio 44103

(216) 773-8277



Molsawat

*** Virtual / Tangible**

June 24, SNAG Gallery Tour 4-10:00PM

Curator: Doug Bucci

*The Cleveland Institute of Art
11141 East Blvd., Cleveland, Ohio 44106
(216) 421-7000*

Hair Jewelry: The Art of Mourning - Fine Jewelry from the Collection

June 15-July 1, 2005

Open Monday- Saturday, 9-5 and Sunday, 12-5

Historic mourning jewelry constructed from human hair, enamel & metal illustrate the 19th century expression of grief through personal adornment.

*Western Reserve Historical Society
1 Wade Oval Drive, University Circle, Cleveland, OH 44106*

BFA Alumni Invitational (Jewelry/Metals/Enameling Department)

June 14-26, 2005

Closing Reception, Sunday, June 26, 2005, 5-7 pm.

Open Sunday June 26, 2005, 12-7.

School of Art Gallery, Kent State University, Kent, OH 44242

Gold.Silver.Platinum

June 10-July 30, 2005

Open Tuesday-Saturday 10-5:30

Open Friday June 24, 2005, 10-9

Open Sunday June 26, 2005, 1-5

Collections of ten internationally known American jewelry designers including: Todd Reed, Sydney Lynch, Judith Neugebauer, Biba Schutz, Terri Logan, Nancy Daniels, Ala Jaron, Catherine Butler, Deborah Woolfork & Talya Baharal



Reed

American Crafts Gallery

3010 Larchmere Blvd. Cleveland, OH 44120, (216) 231-2008



Auman

Exhibition in Motion IV

8-9:00PM Saturday, June 25 at the Rock & Roll Hall of Fame and Museum

Kick off the final night party amidst the glitter and glam of the Rock and Roll Hall of Fame! Approximately 30 artists will strut their stuff down the runway in an interactive fashion show format, emceed by Jordan Davis. Curated by Kathleen Browne and Sherry Simms.

THANK YOU!

We would like to thank all of the volunteers and exhibition planners who generously gave their time and energy to the conference & exhibition planning and production.

(Volunteer names as available at the time of printing)

Committee Chairs and Coordinators:

Sherry Simms - Program Chairperson
Catherine Butler - Logistics Chairperson
Jeanne Dombcik - Exhibitions Chairperson
Kirsten Gatewood - Bus Tour Chairperson
Grace Chin - Workshop Coordinator
Tom Muir, Kathy Buszkiewicz, Susan Skoczen - Student Exhibition
Kim Tatalick, Lanelle Keyes - Student Slide Show
Kristi Kloss, Laurelee Hutson - Volunteer Coordinators
Sandy Kostantaras - Conference Packet Coordinator
Cindy Cetlin - Room Share Coordinator
Courtenay McGowen - Vendor Room Manager
Allyson Cooper, Melissa Manley, Sharon Massey
& Liz Page - SNAG Auction Coordinators
Patti Fields - SNAG Auction Local Coordinator
Nancy Monkman - Photographic Documentation

Carmen Alvarado	Don Freidlich	Brigid O'Hanrahan
Sue Amendolara	Gretchen Goss	Cari Okrez
Megan Auman	Heather Gramont	Michelle Pajak
Gijs Bakker	Mary Gray	Chris Parker
Boris Bally	Jim Henke	Mary Pearse
Kim Baxter	Mike Holmes	Todd Pownell
Gail M. Brown	Mina Hosfield	Suzanne Ramljak
Doug Bucci	Larry Isard	Howard Risatti
William Busta	Lanelle Keyes	Renee Roll
Carole Camillo	Carol Kumata	Debra Rosen
Shane Cartmill	Kirk Lang	Gai Russo
Katy Cassell	Wayne Lawson	Beverly Seley
Susan Channing	Karen Lorene	Cheryl Sheppard
Bruce Checefsky	Thomas Mann	Jennifer Souers
Melissa Cimino	Rod McCormick	Terry Stewart
Cappy Counard	Bruce Metcalf	Dave Stringer
Donna D'Aquino	David Middleton	Kim Tatalick
Jordan Davis	Barbara Minor	Wendy Thumudo
David Deming	Kristy Modarelli	Shelly Warren
Patricia Faber	Susan Myers	Roberta & Dave Williamson
Patti Fields	Johanna Nelson	Joe Wood

Special thanks to Kathleen Browne, Matthew Hollern, Peggy Eng, Melissa Huff, Shefali Kubavat, Kate Lichter, Kristin Shiga, and Dana Singer.

Support Students Donors:

(at time of printing)

Boris Bally	Sumner Silverman
Michael Bennett	Pamela Thomford
Susan Hunt	Jonathan Wahl
Karen Lorene	Barbara Walter

CROWNE PLAZA CLEVELAND CITY CENTRE MEETING ROOMS

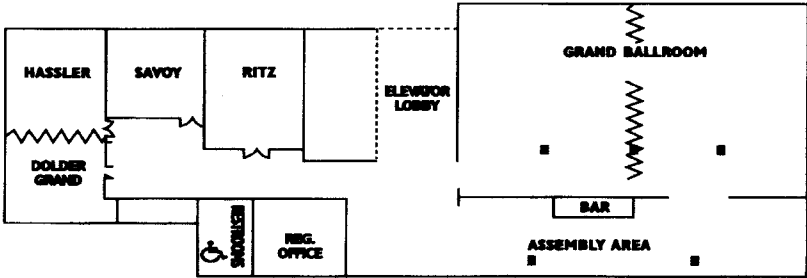

6th Floor Meeting Rooms

(All sessions, Vendor Room, 3M, Registration, Auction, Pin Swap, Coffee Breaks, Voting, Free Literature Tables, Raffle, Member Services Table, Volunteer-Check-In)

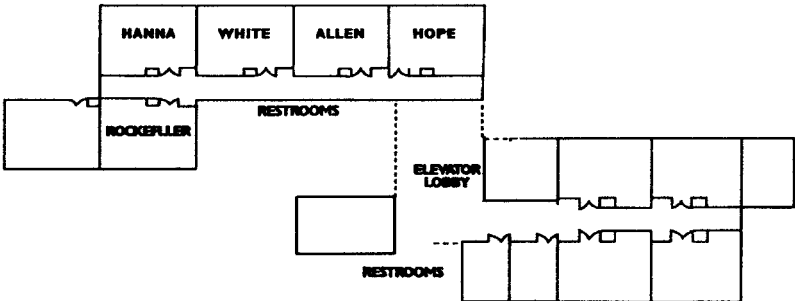

7th Floor Meeting Rooms

(Portfolio Reviews)

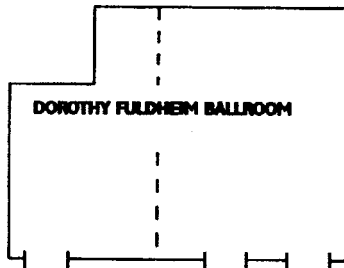

Lobby Level - Dorothy Fuldheim Ballroom

(Pre-conference Professional Development Seminar, Connections Room)